



ST IVES GUILDHALL

Venue Pack

About St Ives Guildhall

The Guildhall is an established, flexible and vibrant multi-purpose venue. The cultural and civic heart of the town since 1939, it has been the main stage of the St Ives September Festival since it began in 1978. Steeped in heritage with great acoustics. It is home and host to all.

The Guildhall is not only the principal venue for the town, but also the largest remaining performance space in West Cornwall. A member of the Music Venue Trust as a grass roots music and art space, the Guildhall is proud to be part of a broad network, working collaboratively to support and create opportunities locally, regionally and nationally. Building on the Guildhall's heritage we work in partnership to develop and deliver high quality experiences that entertain, inspire, celebrate and surprise!

St Ives is internationally renowned for its arts, culture and maritime history. There is a reason why people are drawn here, it might be the light, the people, the beaches, the sea, the twisty tiny medieval streets. There is a magic in this tip of west Cornwall that is captivating, it's hard to put your finger on. It needs to be experienced.

The Guildhall is owned and managed by St Ives Town Council. As a locally led operation, revenue is recycled back into the local community. In 2013, the council committed to develop the hall and in 2019 secured £3.1 million through the St Ives Town Deal. This significant once in a lifetime funding was the catalyst ensuring the council's aspirations were realised. The development of a new fit for purpose venue, which included significant improvements to the technical infrastructure, new comfortable retractable seating, a totally redeveloped level access entrance foyer with a modernised bar café and box office and eye-catching entrance.

The Future is now. The Guildhall opens 2027. We'd love you to be part of it.

About St Ives Guildhall

Programme & Booking

The Guildhall is open to all financial options and partnerships. Hires, ticket splits and guarantee fees. Any and all additional fees, programme development levy and box office commission agreed with details to be included in contracts.

Day and evening rates apply, ranging from a daytime market £275 (+VAT & PRS*) to evening events (2pm get in to 12am with full PA and technical support) £1130 (+VAT +PRS*). Varying get in times available.

*All prices subject to technical set up requirements (please note de-rig charges may apply) and box office**.

Hires Include

- Duty Manager, box office, use of dressing rooms.

Hire Charge Excludes

- Security, subject to the event and venue's risk assessment. Security staff are required for every 100 attendees. This is at the hirers expense. The Guildhall works with local security firms familiar with the venue and is able to get a quote.

Available extras include

- Lighting and sound technical engineers, get in crew
- Merchandise: The Guildhall does not take commission on merchandising and can provide a member of the team to sell merchandise at an additional cost.

**Box Office/ Ticketing

- The Guildhall administers and manages the box office for all events. It is available online, in person and over the phone through both The Cornerstone, St Ives Library & Visitor Information Building (open 6 days a week) and the Guildhall.
- External ticket allocations can be accommodated with large national ticket providers.

Capacity

The Guildhall is a flexible space. From a clear open hall auditorium area ideal for standing gigs, markets, workshops and cabaret to more the traditional theatre seating. The Guildhall's comfy new raked bleacher seating extends from the back of the hall with additional floor matrix seating, plus heritage balcony area.

Auditorium

233 (Fixed seats)

120 (Cabaret style)

Balcony

88 (Fixed seats)

Seated Event Capacity

321 (Seated)

Standing Event Capacity

500+ (Subject to set up)

About St Ives Guildhall

General Information

Age Restrictions

The Guildhall welcomes all ages but please note there will be age restrictions for certain events.

Doors & Curfew

- Door times 7pm standard (but subject to requirements)
- Music 11pm, Get out by midnight (extensions can be applied for subject to licence)

Special Effects

Smoke, haze and pyrotechnics may only be used by prior arrangement. Requests to be made a minimum of 6 working weeks prior to event date, including detailed method statements, risk assessments and insurance.

Marketing & PR

In order for the Guildhall to promote events and its programme, we require promotional material, including:

- High resolution images
- Biographies
- Promotional copy
- Film & photographs

The Guildhall crew will work with you to support and ensure a co-ordinated and effective marketing campaign. We are firm believers in working together to develop, promote and deliver great events and experiences - every time.

The Guildhall will use its marketing channels, including digital platforms and direct mail. We are a member of regional arts marketing platform Cornwall 365, who also produce a seasonal What's On in Cornwall magazine.

Additional local and regional advertising PR campaigns can be arranged at additional cost.

Location

Getting Here

Driving

Approximate drive times:

- Bristol: 3.5 hours
- Exeter: 2 hours
- Plymouth: 1.5 hours

Train

- London Paddington approx 6 hours
- Overnight Riviera Sleeper operated by First Great Western

Coach

- National Express operate a long distance scheduled coach service in and out of Cornwall

Plane

- Newquay Airport is approximately 50 minutes drive from St Ives. Destinations include Stanstead, Gatwick, Birmingham, Manchest, Dublin, Edinburgh and others

Address

St Ives Guildhall
Street an Pol
St Ives
Cornwall
TR26 2DS



In The Area

Train Station • St Ives Station, TR26 2GB • *approx 2 mins drive*

Bus Station • The Malakoff, TR26 2BH • *1 min*

Petrol Station • Texaco, Canon's Town, TR27 6NJ • *15 mins*

Supermarket • Tesco, Carbis Bay, TR27 2PN • *5 mins*

Stage with Retractable & Matrix Seating



Artists Impression

Hall



Artists Impression

Hall with Retractable Seating

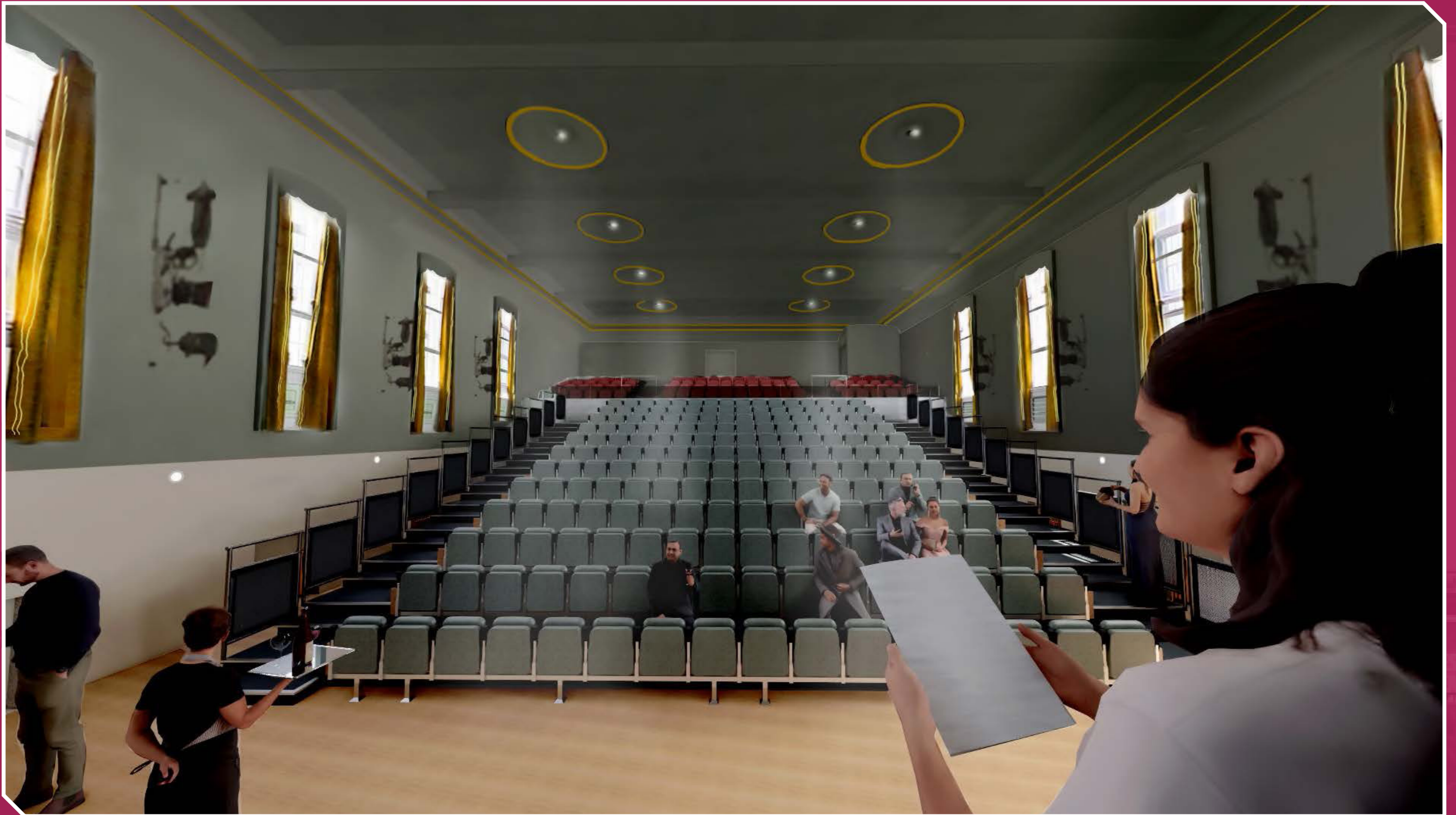

Artists Impression

Bar & Café



Artists Impression

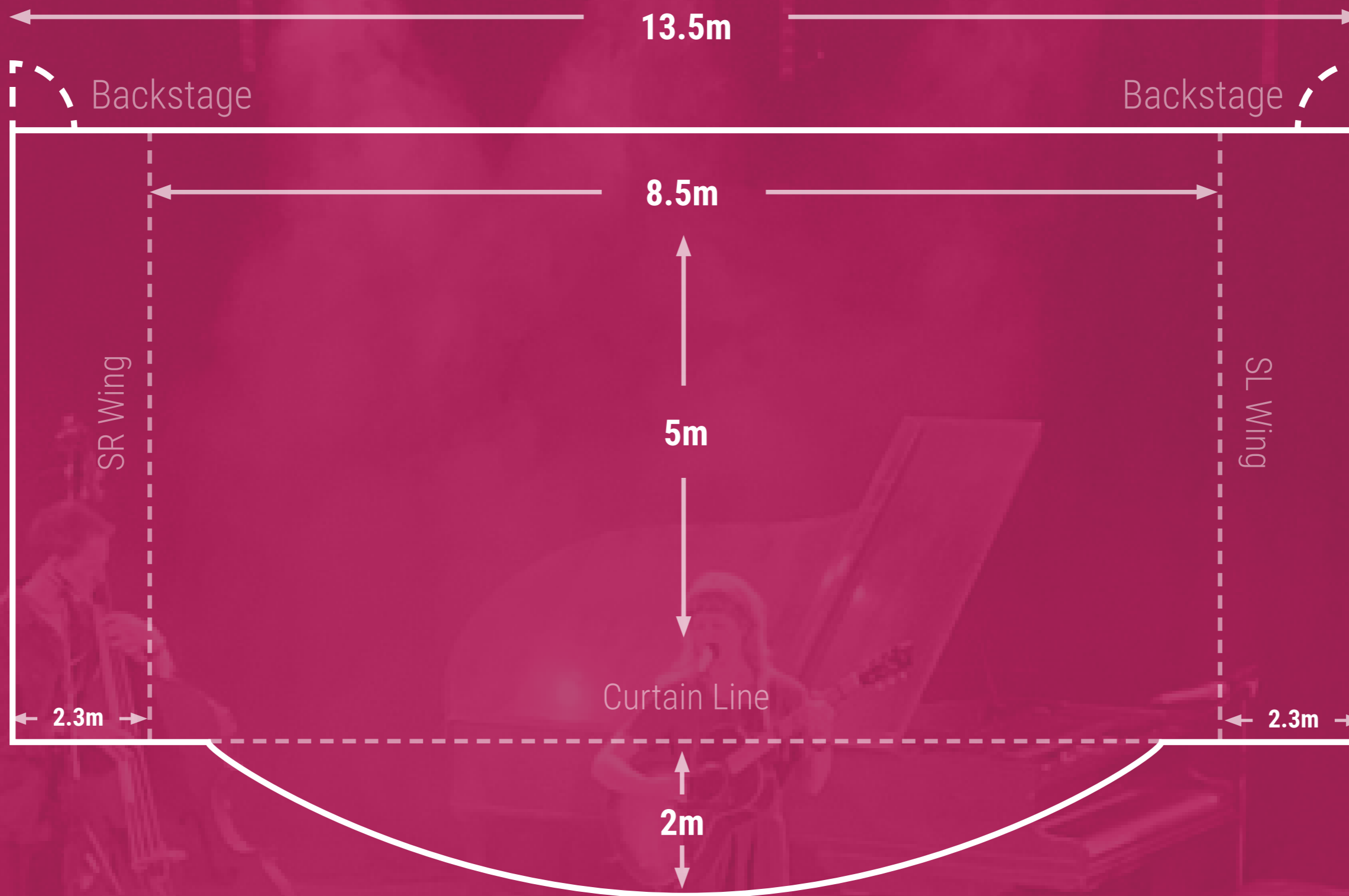

Stage Specs

- 1.1m high (off hall floor)
- Playing space 8.5m wide
- 2.3m wings
- 5m deep (to curtain line)

Auditorium has a hard wood dance floor. The WCs are under the stage, accessed via stairwells from the auditorium left & right of the proscenium arch. This means no ground stacked PA or equipment in these areas.

Equipment/Fly System

- Drum Riser/Stage Blocks
- Zarges 14-rung Step Ladder
- Scaffold Tower

These may not be stored on site so please discuss in advance if needed.

- We have 3x LX fly bars on a drill drive winch system
- 3x hemp set scenery bars
- Front and rear fixed drape tracks
- Mid-stage crossover drapes
- Fixed border bars
- 1 pair tab side legs with swivel action

Back Stage

- 2x Dressing rooms with sink (located behind stage, same level) Each with show relay, intercom, 75-ohm coax, data [AV], paging
- 1x Toilets (located downstairs)
- 1x Kitchen facility (microwave, fridge, sinks etc.)

If additional dressing room space is required, please let us know in advance

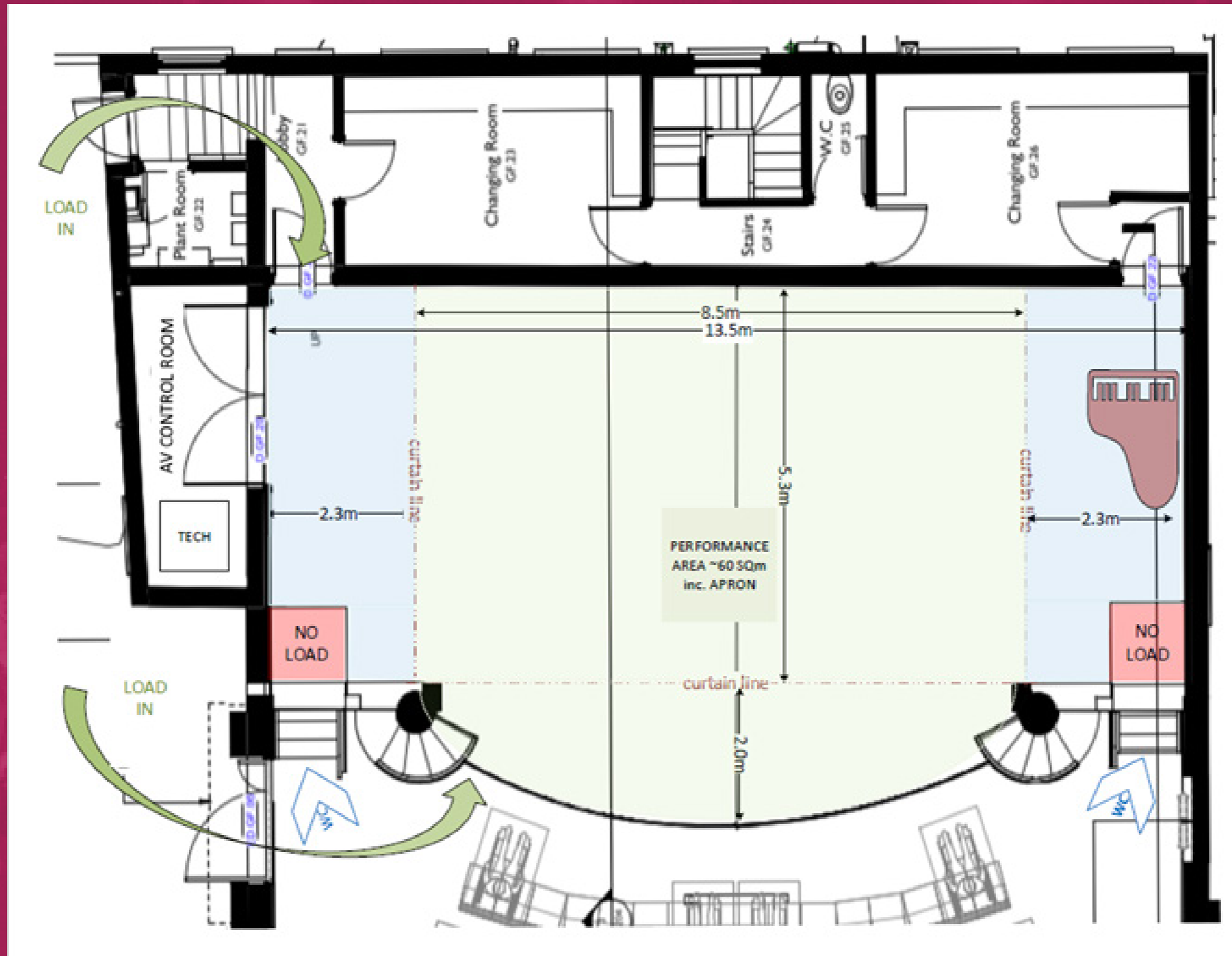

Power

DSL:	1x 63A TPN Switched Interlock Local RCD.
USL:	4x 13A.
DSR:	1x 32A SPN. 4x 13A.
USR:	1x 32A SPN. 4x 13A.
LX Bars [1-3]:	1x 16A SPN. Plus LX Bar 2 has 1x 32A SPN [AV]. 4x 13A [AV].
Auditorium Trusses:	[1] 32A SPN [LX]. 4x 16A SPN [LX]. [2] 4x 16A SPN [LX]. [3] 32A SPN [LX]. 3x 16A SPN [LX]. [4] 4x 16A SPN [LX]. Plus [1-4] have 1x powerCON TRUE1 [AV].
House Booms:	L&R [1-4]. 1x powerCON TRUE1 [LX] plus 1x powerCON TRUE [AV].
Auditorium Rear:	1x 32A SPN. 2x 13A.
Front Terrace:	1x 32A SPN. 1x 16A SPN. Backline/temporary/loose 32A > 16A distro, plus 16A runs to 13A power strips.

Channels

48-channels of direct power via relay switchable (DMX) circuits. These channels will be distributed around the venue at high-level and to low-level facility panels to a selection of 32A, 16A and PowerCon True1 outlet sockets.

PA System

The Guildhall is equipped with a high quality PA system consisting of:

- Flown line array either side of the proscenium arch which will adequately cover the auditorium floor and balcony seating.
- Additional delay speakers will provide coverage in key areas at the rear of the hall and under the balcony where needed.
- A flown centre array to enhance vocal intelligibility.
- Sub-bass speakers mounted in alcoves in the stage front at floor level.

Mixing Desk

Different levels of mixing control can be provided depending on the production

- A 'day rack' for simple programme as default, providing a CD player, Bluetooth input, a wireless microphone and local line inputs for a computer, DJ, artists mixer.
- For more comprehensive setups, a 48-channel digital mixing console can be provided at two front of house positions, either on the hall floor or on the balcony where facility panels are located.
- Up to 10 stage monitor mixes can be provided via 12" and 15" powered speakers. Additional mixes for personal monitoring may also be configured.
- Monitors can be mixed from the front of house console, via a tablet onstage, or using a dedicated digital monitor console onstage if required, which utilise an analogue split to allow independent gain control.

Microphones

A comprehensive collection of industry standard dynamic and condenser microphones are available

- Direct-injection boxes and requisite cabling, stands and mains distribution allow for flexible set-ups onstage and around the building as required.
- Manufacturer proprietary and Dante digital audio networking facilitate multi-channel audio distribution throughout the venue.
- There is no analogue multicore (snake). LC-Duplex OM4 multi mode fibre cable, 75ohm video, DMX, show power and intercom ring. infrastructure are provided
- A venue wide background music system with paging is provided, including show relay to dressing rooms.

Backstage

Backstage and FoH control areas have dedicated audio network distribution to break-in/out panels (Dante capable). With patch bay, analogue audio tie-lines [BUT NO ANALOGUE MULTICORE RUN!]. LC-Duplex OM4 Multi Mode Fibre Cable, 75ohm video, DMX, show power, intercom ring.

Equipment

- 8x Shure SM58
- 4x Shure beta58
- 8x SM57, e906 or equivalent
- 1x Audix PD7 Drum microphone set or equivalent
- 4x Sennheiser E614 Electret or equivalent
- 2x Sennheiser ME36 or equivalent
- 6x Active DI box J48 or equivalent
- 2x Sennheiser EWD - ME2 set radio lavalier microphones or equivalent
- 4x Sennheiser EWD - ME2 set radio handheld microphones or equivalent
- 1x Behringer ultra-DI pro 8 DI box
- 1x Samson Drum microphone set
- 8x K&M short boom microphone stands
- 10x K&M tall boom microphone stands

Equipment

Lighting control console:	Zero88 FLX 2048 with 2x 22" touchscreens
Auditorium front truss/booms:	8x Chauvet Ovation E-2 FC or equivalent
General lighting fixtures stock:	10x American DJ focus spot three Z 2x American DJ Entour venue haze machines + 5ltr hazer fluid 5x American DJ ultra bar 12 2x Tungsten follow spots and flight case 6x Chauvet DJ Core 80 on stands 14x IMG stage line PARC-64/RGB Barco 63000 Graphic in flying frame [stored off-stage] 2x Fusion Equinox heads

Lighting Desk

An industry standard lighting desk will control the stage lighting equipment via standard DMX protocol. DMX inputs at low level and DMX outputs across the venue facility panels. These will be star wired to a DMX patch panel where there will also be distribution provided by DMX splitters. Control via lighting network protocol can be achieved using the installed distributed network tie lines.

The primary temporary lighting control locations will be at rear stalls level and the rear of the technical balcony. House lights and architectural lights will be DMX controlled.

Get In

Loading into the venue can be done via the side double doors which are accessible to the left hand side of the venue (Sugar Lane, TR26 1FU). This lane is in constant use but would allow a long-wheelbase van to reverse down for loading. This is level access directly onto the hall floor in front (1.1m below) the stage. There are steps up onto stage-left and stage-right, or a ramp could be provided.

Alternatively, there is a single door at the end of the building past the double doors mentioned. There are six steps from this door to the stage and dressing rooms level.

Parking

St Ives is unsuitable for HGVs due to its tight and narrow roads, we advise large trucks to cross load to bring kit to the Guildhall. Parking is available throughout town, the closest being the Station Car Park (TR26 2AS), 5 mins walk to the venue.

There is temporary parking available for loading and unloading, however parking at the venue is limited, please discuss this with our programming team.

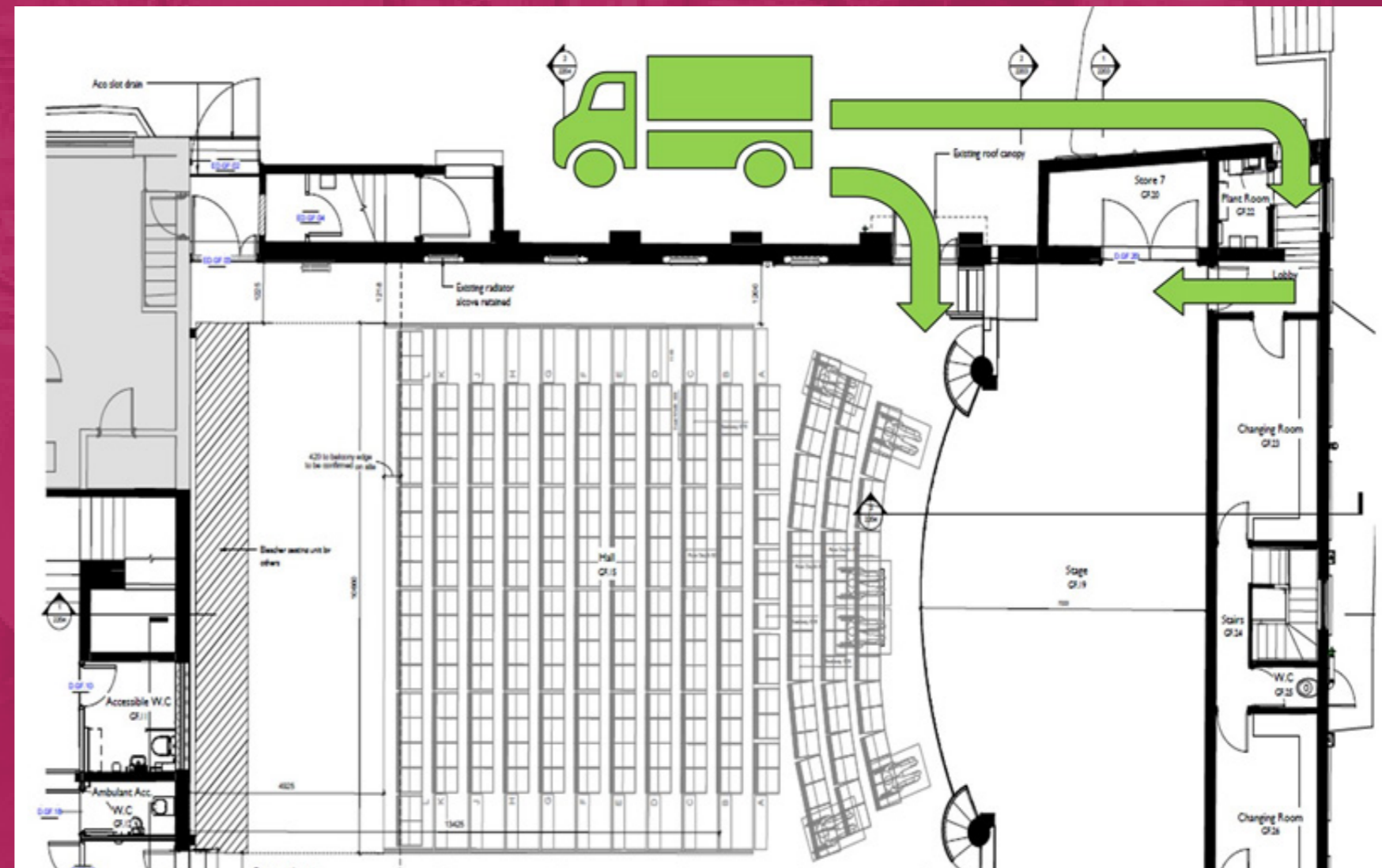

Contact Info

If you have any questions or queries, don't hesitate to contact us:

General Enquiries & Hire

programming@stivesguildhall.co.uk
01736 797840

Programme

Emma Gibson: emma.gibson@stives-tc.gov.uk

General Manager & Technical Lead

Léon Phillips: leon.phillips@stives-tc.gov.uk



St Ives Town Council

ST IVES **GUILDHALL**